

EPDM Insulation Jackets - Equal Length Tees

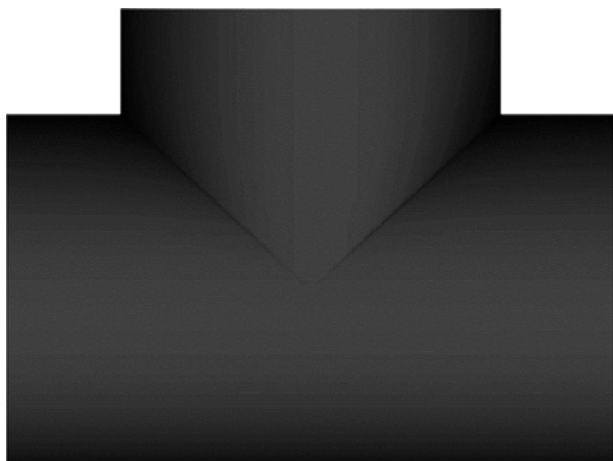

PRODUCT

Fabricated elbows made from Aeroflex Standard EPDM Insulation for use in refrigeration and HVAC applications. Designed to fit standard equal-length tee fittings. Meets 25/50 Fire and Smoke rating and has a working temperature range from -70 °F to 257 °F (-57 °C to 125 °C).

INSULATION SPECS

Material: Low-density EPDM closed cell elastomeric foam, CFC and HCFC gas free.

Thermal Conductivity: 0.235 (BTU * in/h *ft² * °F) at 75°F.

Water Vapor Permeability: <0.03 perm-in. (4.38 x 10⁻¹¹g/Pa*s*m) per ASTM E96.

Water Absorption: <0.2% by volume per ASTM C 209.

Working Temperature: -70 °F to 257 °F (-57 °C to 125 °C) continuous per ASTM C 411.

Surface Burning Characteristics: Meets 25/50 Flame-Spread/Smoke-Generated per UL 723 and ASTM E84. Additionally meets UL-94 5 V-A, V-0 and is self-extinguishing per ASTM D 635.

UV Resistant: EPDM provides UV Resistance in accordance with ASTM G7/G90.

Ozone Resistant: Meets ASTM D 1171.

Color: Black

Thickness: 1/2", 3/4", 1", 1-1/2", and 2" available.

SPECIAL FEATURES

ASTM E84 (25/50) compliant: Flame-Spread index under 25 and Smoke Development Index under 50 (tested according to ASTM E84).

Ozone Resistant: Provides ozone resistance in accordance with ASTM D 1171.

Non-Polar: Non-Corrosive to copper and stainless steel and helps repel water vapor.

NOTE: Quantities are estimates only. Contractor is responsible for quantities required on project.

Qty.	Product #	Tube Size	Insulation Thickness	R Value	Qty.	Product #	Tube Size	Insulation Thickness	R Value	Qty.	Product #	Tube Size	Insulation Thickness	R Value
	T-1212	1/2"	1/2"	3.4		T-1210	1/2"	1"	8.2		T-1220	1/2"	2"	20.2
	T-5812	5/8"	1/2"	3.2		T-5810	5/8"	1"	7.7		T-5820	5/8"	2"	18.9
	T-3412	3/4"	1/2"	3.0		T-3410	3/4"	1"	7.3		T-3420	3/4"	2"	17.9
	T-7812	7/8"	1/2"	2.9		T-7810	7/8"	1"	7.0		T-7820	7/8"	2"	17.1
	T-11812	1-1/8"	1/2"	2.8		T-11810	1-1/8"	1"	6.5		T-11820	1-1/8"	2"	15.9
	T-13812	1-3/8"	1/2"	2.6		T-13810	1-3/8"	1"	6.2		T-13820	1-3/8"	2"	15.0
	T-15812	1-5/8"	1/2"	2.6		T-15810	1-5/8"	1"	5.9		T-15820	1-5/8"	2"	14.3
	T-21812	2-1/8"	1/2"	2.5		T-21810	2-1/8"	1"	5.6		T-21820	2-1/8"	2"	13.2
	T-1234	1/2"	3/4"	5.7		T-12112	1/2"	1-1/2"	13.9					
	T-5834	5/8"	3/4"	5.3		T-58112	5/8"	1-1/2"	13.0					
	T-3434	3/4"	3/4"	5.0		T-34112	3/4"	1-1/2"	12.3					
	T-7834	7/8"	3/4"	4.8		T-78112	7/8"	1-1/2"	11.8					
	T-11834	1-1/8"	3/4"	4.5		T-118112	1-1/8"	1-1/2"	10.9					
	T-13834	1-3/8"	3/4"	4.3		T-138112	1-3/8"	1-1/2"	10.3					
	T-15834	1-5/8"	3/4"	4.2		T-158112	1-5/8"	1-1/2"	9.9					
	T-21834	2-1/8"	3/4"	4.0		T-218112	2-1/8"	1-1/2"	9.2					