

# EPDM Insulation Jackets - 90° XLR Elbows For Field-Bent Tubing

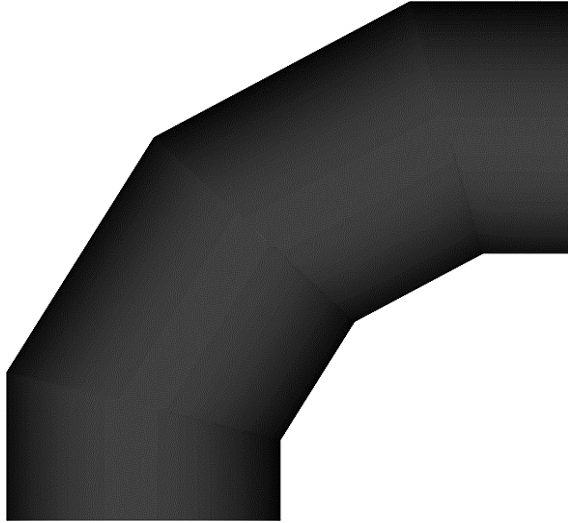

## PRODUCT

Mitred elbows made from Aeroflex Standard EPDM Insulation for use in refrigeration and HVAC applications. Designed to fit tubing bent with the Imperial 370-FH bender or the Reftekk Digi-Bender. Meets 25/50 Fire and Smoke rating and has a working temperature range from -70 °F to 257 °F (-57 °C to 125 °C).

## INSULATION SPECS

**Material:** Low-density EPDM closed cell elastomeric foam, CFC and HCFC gas free.

**Thermal Conductivity:** 0.235 (BTU \* in/h \*ft<sup>2</sup> \* °F) at 75°F.

**Water Vapor Permeability:** <0.03 perm-in. (4.38 x 10-11g/Pa\*s\*m) per ASTM E96.

**Water Absorption:** <0.2% by volume per ASTM C 209.

**Working Temperature:** -70 °F to 257 °F (-57 °C to 125 °C) continuous per ASTM C 411.

**Surface Burning Characteristics:** Meets 25/50 Flame-Spread/Smoke-Generated per UL 723 and ASTM E84. Additionally meets UL-94 5 V-A, V-0 and is self-extinguishing per ASTM D 635.

**UV Resistant:** EPDM provides UV Resistance in accordance with ASTM G7/G90.

**Ozone Resistant:** Meets ASTM D 1171.

**Color:** Black

**Thickness:** 1", 1-1/2", and 2" available.

**Sizing:** Elbows 1/4" thru 1/2" designed to fit tubing bent with Imperial 370-FH. Elbows 5/8" thru 1-3/8" designed to fit tubing bent with Reftekk Digi-Bender.

## SPECIAL FEATURES

**ASTM E84 (25/50) compliant:** Flame-Spread index under 25 and Smoke Development Index under 50 (tested according to ASTM E84).

**Ozone Resistant:** Provides ozone resistance in accordance with ASTM D 1171.

**Non-Polar:** Non-Corrosive to copper and stainless steel and helps repel water vapor.

NOTE: Quantities are estimates only. Contractor is responsible for quantities required on project.

Qty.	Product #	Tube Size	Insulation Thickness	R Value	For Tubing Bent With
	ELX1410XLR	1/4"	1"	10.1	Imperial 370-FH
	ELX3810XLR	3/8"	1"	8.9	Imperial 370-FH
	ELX1210XLR	1/2"	1"	8.2	Imperial 370-FH
	ELX5810XLR	5/8"	1"	7.7	Digi-Bender
	ELX3410XLR	3/4"	1"	7.3	Digi-Bender
	ELX7810XLR	7/8"	1"	7.0	Digi-Bender
	ELX11810XLR	1-1/8"	1"	6.5	Digi-Bender
	ELX13810XLR	1-3/8"	1"	6.2	Digi-Bender
N/A	N/A	1/4"	1-1/2"	17.0	N/A
N/A	N/A	3/8"	1-1/2"	15.1	N/A
	ELX12112XLR	1/2"	1-1/2"	13.9	Imperial 370-FH
	ELX58112XLR	5/8"	1-1/2"	13.0	Digi-Bender
	ELX34112XLR	3/4"	1-1/2"	12.3	Digi-Bender
	ELX78112XLR	7/8"	1-1/2"	11.8	Digi-Bender
	ELX118112XLR	1-1/8"	1-1/2"	10.9	Digi-Bender
	ELX138112XLR	1-3/8"	1-1/2"	10.3	Digi-Bender

Qty.	Product #	Tube Size	Insulation Thickness	R Value	For Tubing Bent With
N/A	N/A	1/4"	2"	24.6	N/A
N/A	N/A	3/8"	2"	21.9	N/A
	ELX1220XLR	1/2"	2"	20.2	Imperial 370-FH
	ELX5820XLR	5/8"	2"	18.9	Digi-Bender
	ELX3420XLR	3/4"	2"	17.9	Digi-Bender
	ELX7820XLR	7/8"	2"	17.1	Digi-Bender
	ELX11820XLR	1-1/8"	2"	15.9	Digi-Bender
	ELX13820XLR	1-3/8"	2"	15.0	Digi-Bender